



Facility Summary

Client: Vernon Public Schools

Facility: Vernon Center Middle School

Facility Data	
Address 1	777 Hartford Turnpike
Address 2	-
City	Vernon
State	CT
ZIP	06066
Type of Facility	School
Square Footage	88,327

Notes

There are 2 different types of roof systems on this building:

- 25,132 sq. ft. Ballasted EPDM
- 65,195 sq. ft. Mineral Surfaced Modified Bitumin

Roof Sections			
Name	Date Installed	Square Footage	Roof Access
Ballasted EPDM		25,132	Ladder Needed
Mineral Surfaced Modified Built-Up		65,195	Ladder Needed



since 1895

ROOF MEASUREMENT REPORT

777 Hartford Turnpike, Vernon, CT 06066

Report Contents



Images	1
Length Diagram.....	4
Pitch Diagram.....	5
Area Diagram	6
Penetrations Diagram	7
Notes Diagram	8
Property Info.....	9
Report Summary.....	10

Report Details

Date:	02/28/2013
Report:	5464584
Building:	1

Roof Details

Total Area:	39,120 sq ft
Total Roof Facets:	6
Predominant Pitch:	0/12
Number of Stories:	>1
Total Ridges/Hips:	0 ft
Total Valleys:	0 ft
Total Rakes:	0 ft
Total Eaves:	0 ft
Total Penetrations:	17
Total Penetrations Perimeter:	325 ft
Total Penetrations Area:	435 sq ft

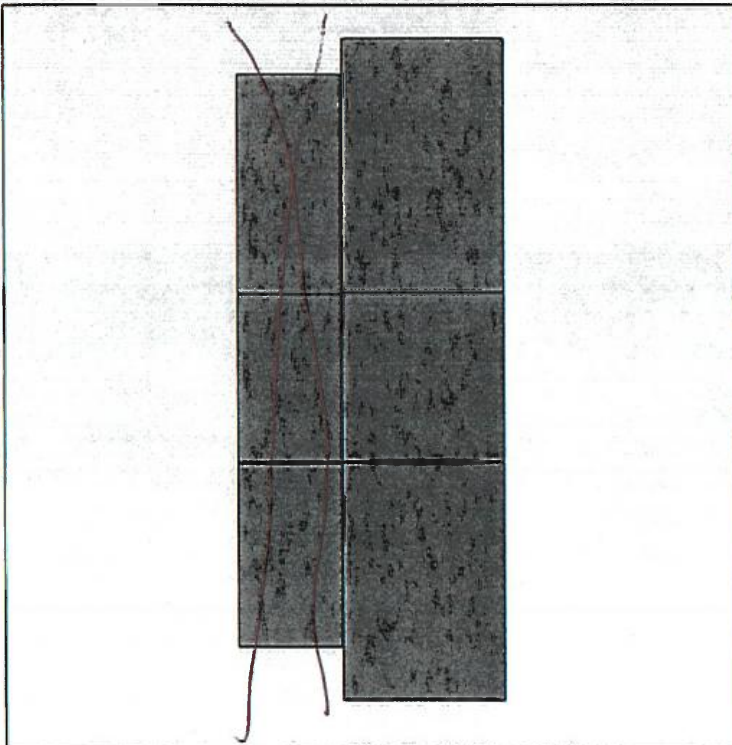

In this 3D model, facets appear as semi-transparent to reveal overhangs.

Contact Us

Contact: Tim Mulcahy
 Company: The Garland Company Inc.
 Address: 3800 East 91st St
 Cleveland OH 44105
 Phone: 216-641-7500

Measurements provided by www.eagleview.com



Certified Accurate

www.eagleview.com/Guarantee.aspx

This document is provided under License by EagleView Technologies to the requestor for their Internal Use Only subject to the terms and conditions previously agreed to by the requestor when they registered for use of EagleView Technologies Services. It remains the property of EagleView Technologies and may be reproduced and distributed only within the requestor's company. Any reproduction or distribution to anyone outside of the requestor's company without EagleView's prior written permission is strictly prohibited. All aspects and handling of this report are subject to the Terms and Conditions previously agreed to by the requestor.

Copyright ©2008-2013 EagleView Technologies, Inc. - All Rights Reserved- Covered by U.S. Patent Nos. 8,078,436; 8,145,578; 8,170,840 and 8,209,152. Other Patents Pending.





REPORT IMAGES

The following aerial images show different angles of this structure for your reference.



Top View

This document is provided under License by EagleView Technologies to the requestor for their Internal Use Only subject to the terms and conditions previously agreed to by the requestor when they registered for use of EagleView Technologies Services. It remains the property of EagleView Technologies and may be reproduced and distributed only within the requestor's company. Any reproduction or distribution to anyone outside of the requestor's company without EagleView's prior written permission is strictly prohibited. All aspects and handling of this report are subject to the Terms and Conditions previously agreed to by the requestor.

Copyright ©2008-2013 EagleView Technologies, Inc. - All Rights Reserved - Covered by U.S. Patent Nos. 8,078,438; 8,145,578; 8,170,840 and 8,209,152. Other Patents Pending.



REPORT IMAGES

North View



East View

This document is provided under License by EagleView Technologies to the requestor for their Internal Use Only subject to the terms and conditions previously agreed to by the requestor when they registered for use of EagleView Technologies Services. It remains the property of EagleView Technologies and may be reproduced and distributed only within the requestor's company. Any reproduction or distribution to anyone outside of the requestor's company without EagleView's prior written permission is strictly prohibited. All aspects and handling of this report are subject to the Terms and Conditions previously agreed to by the requestor.



REPORT IMAGES



South View

West View

This document is provided under License by EagleView Technologies to the requestor for their Internal Use Only subject to the terms and conditions previously agreed to by the requestor when they registered for use of EagleView Technologies Services. It remains the property of EagleView Technologies and may be reproduced and distributed only within the requestor's company. Any reproduction or distribution to anyone outside of the requestor's company without EagleView's prior written permission is strictly prohibited. All aspects and handling of this report are subject to the Terms and Conditions previously agreed to by the requestor.

Copyright ©2008-2013 EagleView Technologies, Inc. - All Rights Reserved - Covered by U.S. Patent Nos. 8,078,436; 8,145,578; 8,170,840 and 8,209,152. Other Patents Pending.



ROOF MEASUREMENT REPORT

LENGTH DIAGRAM

Total Line Lengths: Ridges = 0 ft Valleys = 0 ft Flashing = 0 ft Eaves = 0 ft
 Hips = 0 ft Rakes = 0 ft Step flashing = 0 ft Parapets = 1,969 ft

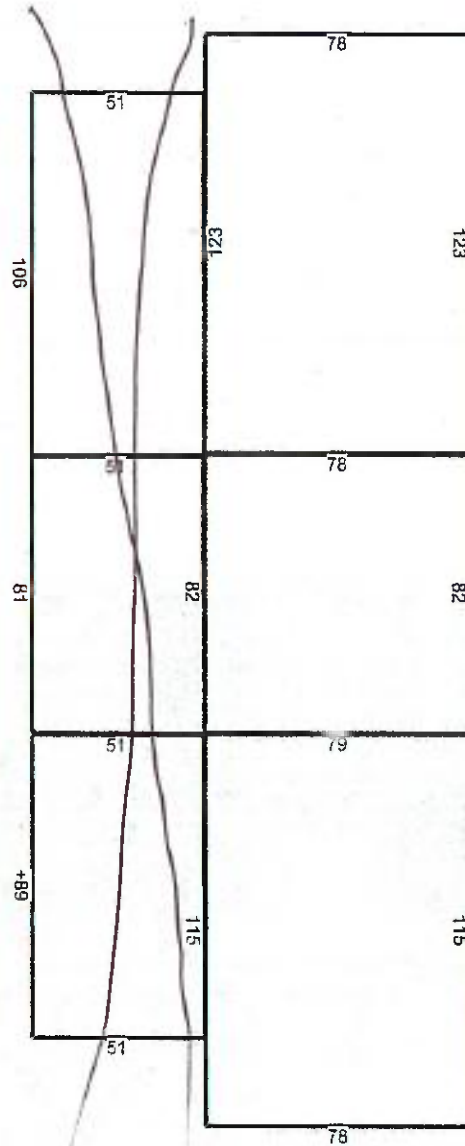

© 2013 EagleView Technologies, Inc.



Note: This diagram contains segment lengths (rounded to the nearest whole number) over 5 feet. In some cases, segment labels have been removed for readability. Plus signs preface some numbers to avoid confusion when rotated (e.g. +6 and +9).

This document is provided under License by EagleView Technologies to the requestor for their Internal Use Only subject to the terms and conditions previously agreed to by the requestor when they registered for use of EagleView Technologies Services. It remains the property of EagleView Technologies and may be reproduced and distributed only within the requestor's company. Any reproduction or distribution to anyone outside of the requestor's company without EagleView's prior written permission is strictly prohibited. All aspects and handling of this report are subject to the Terms and Conditions previously agreed to by the requestor.

Copyright ©2008-2013 EagleView Technologies, Inc. – All Rights Reserved – Covered by U.S. Patent Nos. 8,078,436; 8,145,578; 8,170,840 and 8,208,152. Other Patents Pending.



PITCH DIAGRAM

Pitch values are shown in inches per foot, and arrows indicate slope direction. The predominant pitch on this roof is 0/12.

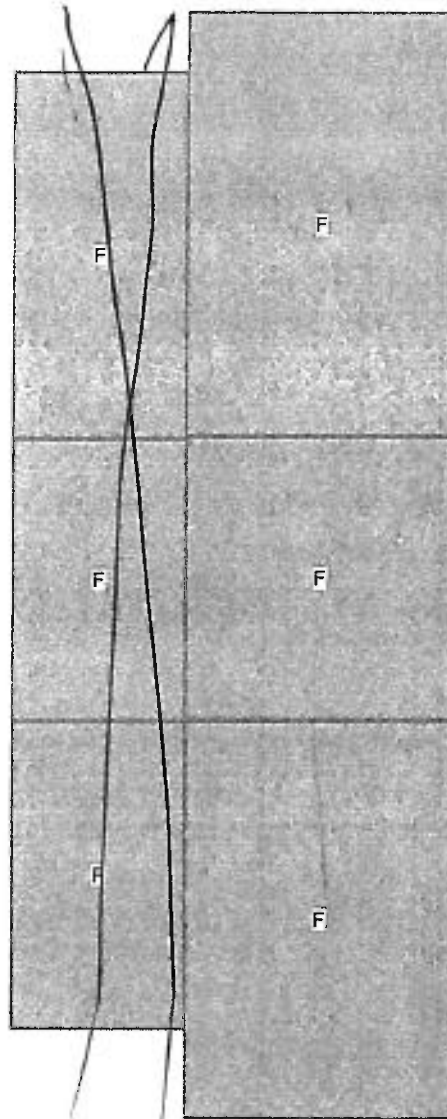

2013 EagleView Technologies, Inc.

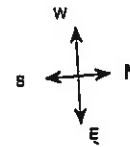

Note: This diagram contains labeled pitches for facet areas larger than 20 square feet. In some cases, pitch labels have been removed for readability. Gray shading indicates flat, 1/12 or 2/12 pitches. If present, a value of "F" indicates a flat facet (no pitch).

This document is provided under License by EagleView Technologies to the requestor for their Internal Use Only subject to the terms and conditions previously agreed to by the requestor when they registered for use of EagleView Technologies Services. It remains the property of EagleView Technologies and may be reproduced and distributed only within the requestor's company. Any reproduction or distribution to anyone outside of the requestor's company without EagleView's prior written permission is strictly prohibited. All aspects and handling of this report are subject to the Terms and Conditions previously agreed to by the requestor.



AREA DIAGRAM

Total Area = 39,120 sq ft, with 6 facets.

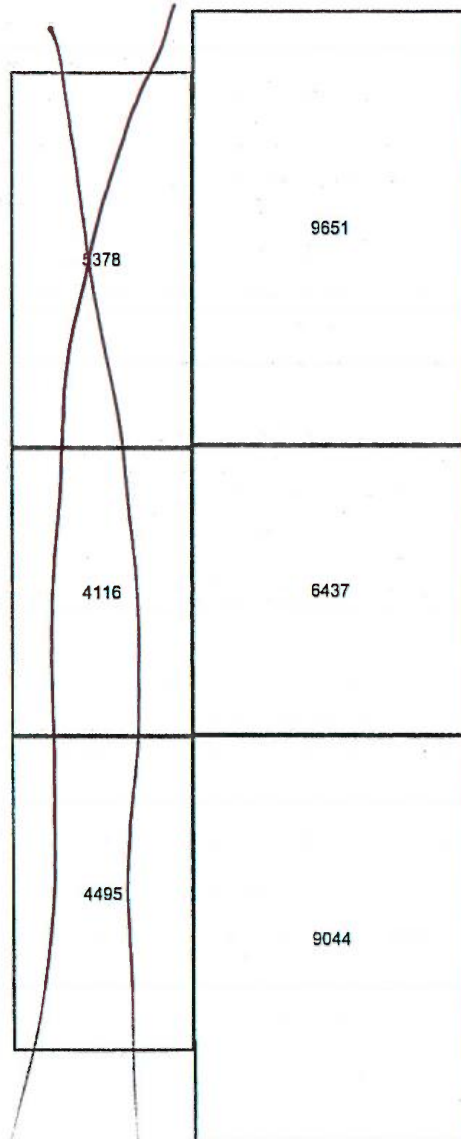

© 2013 EagleView Technologies, Inc.

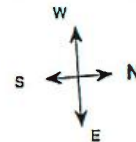

Note: This diagram shows the square feet of each roof facet (rounded to the nearest foot). The total area in square feet, at the top of this page, is based on the non-rounded values of each roof facet (rounded to the nearest square foot after being totaled).

This document is provided under License by EagleView Technologies to the requestor for their Internal Use Only subject to the terms and conditions previously agreed to by the requestor when they registered for use of EagleView Technologies Services. It remains the property of EagleView Technologies and may be reproduced and distributed only within the requestor's company. Any reproduction or distribution to anyone outside of the requestor's company without EagleView's prior written permission is strictly prohibited. All aspects and handling of this report are subject to the Terms and Conditions previously agreed to by the requestor.



PENETRATIONS

Penetrations Notes Diagram

Penetrations are labeled from smallest to largest for easy reference.

Total Penetrations: 17

Total Penetrations Perimeter = 325 ft

Total Penetrations Area: 435 sq ft

Total Roof Area Less Penetrations = 38,686 sq ft

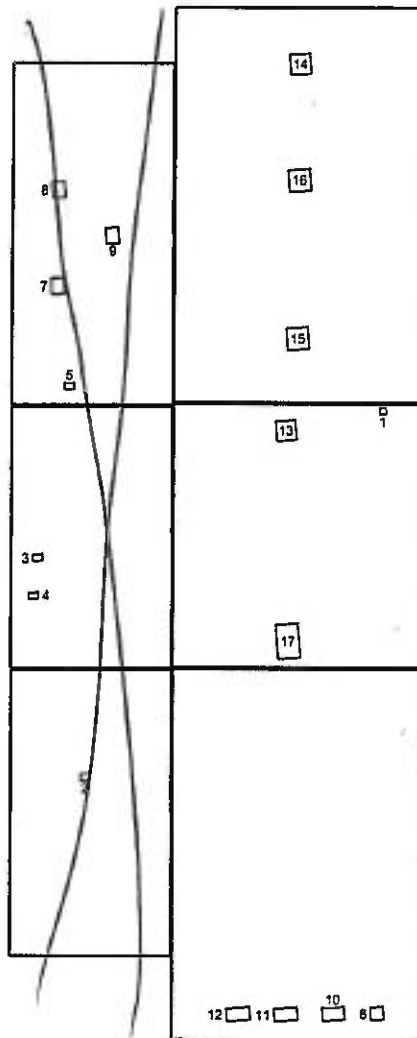

© 2013 EagleView Technologies, Inc.

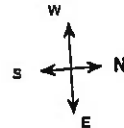

Note: Any measured penetration smaller than 3x3 feet may need field verification. Accuracy is not guaranteed. The total penetration area is not subtracted from the total roof area.

This document is provided under License by EagleView Technologies to the requestor for their Internal Use Only subject to the terms and conditions previously agreed to by the requestor when they registered for use of EagleView Technologies Services. It remains the property of EagleView Technologies and may be reproduced and distributed only within the requestor's company. Any reproduction or distribution to anyone outside of the requestor's company without EagleView's prior written permission is strictly prohibited. All aspects and handling of this report are subject to the Terms and Conditions previously agreed to by the requestor.